

# Arch 125

## Class-07 Spring 2010

### Class SEVEN: Presentation

Viewport Shading \_ Cameras \_ Site Extrude \_ Directional Light (Sunlight) \_ Photoshop - canvas, guides, scale, text

### Design Development

Presentation Tutorial: Rhino, Photoshop

**STEP ONE:** open **Rhino** \_ open your class06.3dm \_ file save as \_ make a class-07 / rhino folder and save it as class-07.3dm \_ from the main menu / edit / layers \_ select All Layers On

**STEP TWO:** in the perspective view \_ right click to set up a view similar to image 2 \_ right click on the viewport name Perspective \_ select **Ghosted** from the flyout \_ print screen \_ open Photoshop \_ **ctrl + n** (open new file \_ **ctrl + v** (paste)

**STEP THREE:** from the osnap settings at the bottom of the screen click on **Disable** \_ from the main menu / view / Set camera / **Place camera and Target**

**STEP FOUR:** click in the top viewport to place the Camera \_ click in the middle of the pavilion to place the target

**STEP FIVE:** right click on the name of the top viewport \_ select **Viewport Properties** from the flyout menu

**STEP SIX:** change the name of the viewport to **Ext Cam 01** \_ change the projection to **Perspective** \_ change the camera lens to **28 mm** \_ type **Camera** \_ click on **Show** \_ move the target as needed from the **Front** view

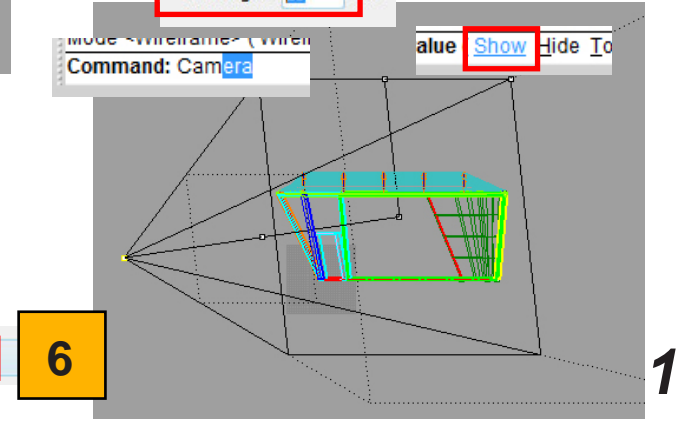
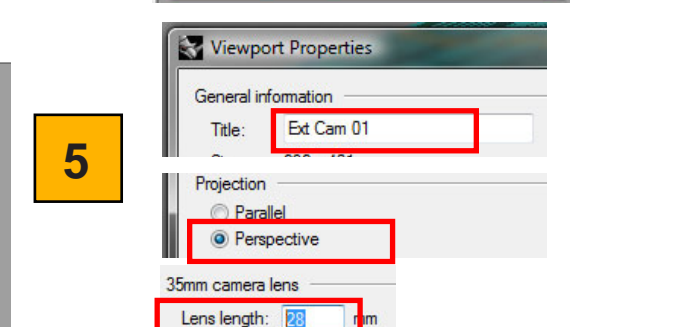
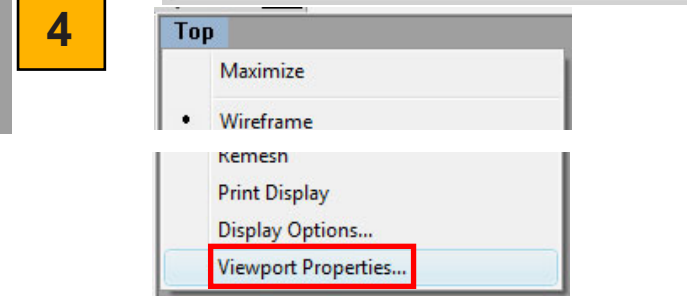
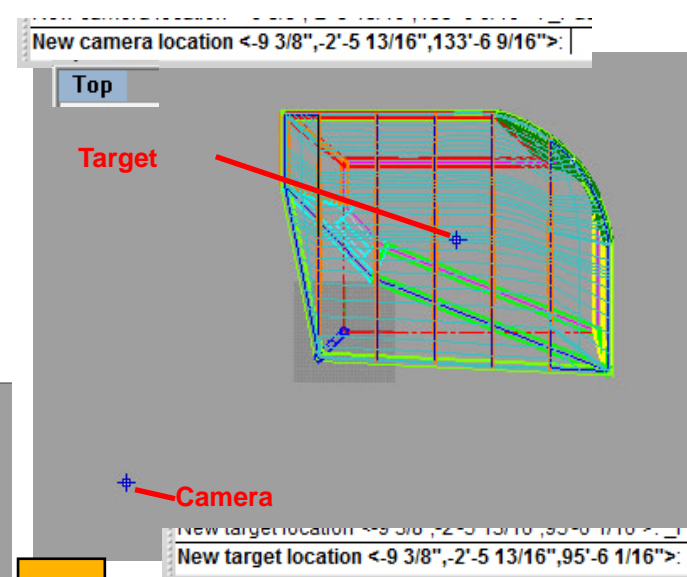
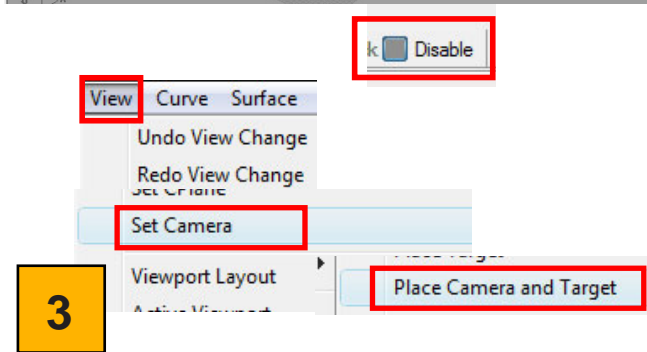
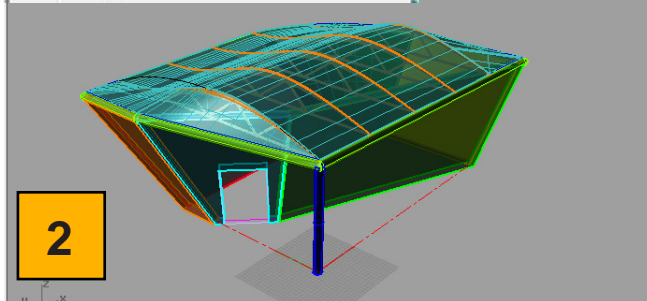
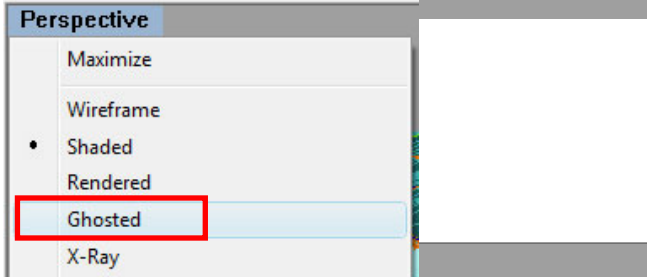
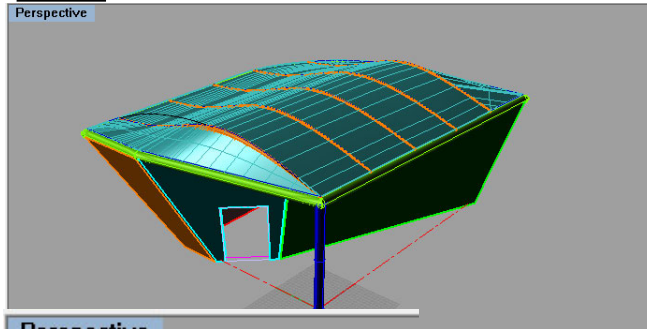
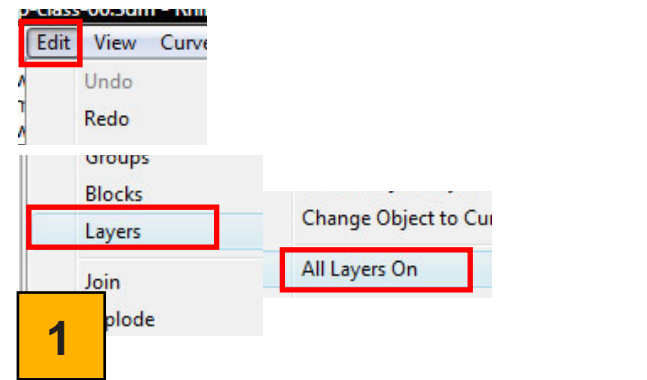

Arch 125  
Class-07 Spring 2010

**Class SEVEN: Presentation**

Viewport Shading \_ Cameras \_ Site Extrude \_ Directional Light (Sunlight) \_ Photoshop - canvas, guides, scale, text

**STEP SEVEN:** we will need to model the site area \_ open AutoCad and open your class-03 site mapping diagram \_ freeze all of the layers except for Site outline & Footprint \_ draw 2 reference lines as shown in image 8

**STEP EIGHT:** move the objects from the intersection of the reference lines to **#0,0,0**

**STEP NINE:** type **WBlock** \_ select objects \_ create a class-07 / export folder \_ save as: site-area.dwg \_ change the Files of Type to **AutoCad 2007**

**STEP TEN:** ctrl+tab over to Rhino \_ from the main menu / file import \_ (**note:** the perspective view will change) \_ main menu / view / **undo view change** \_ type **ExtrudeCRv** \_ set BothSides = **No** \_ set Cap=**Yes** \_ type **6"** for extrusion distance \_ enter \_ place the site extrusion on the site outline layer

**STEP ELEVEN:** create a Sunlight using a Directional light \_ main menu / render / **Create Directional Light**

**STEP TWELVE:** position light as shown in image 12 using **move** and **rotate** commands

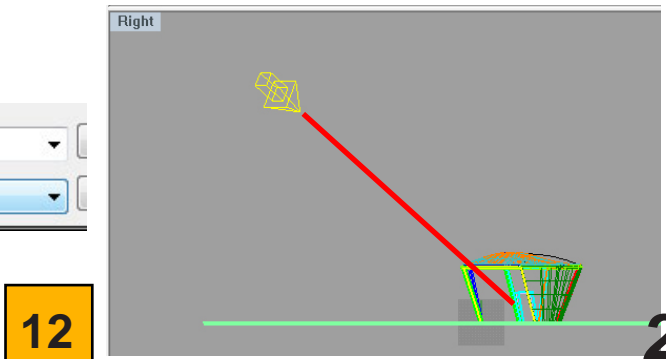
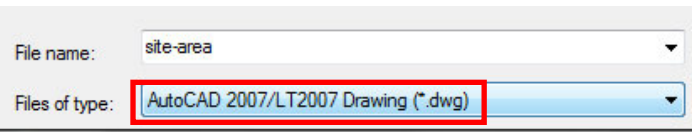
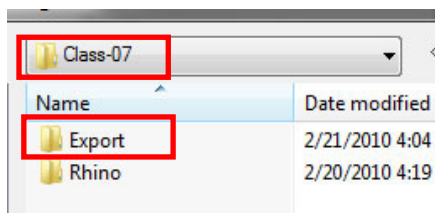
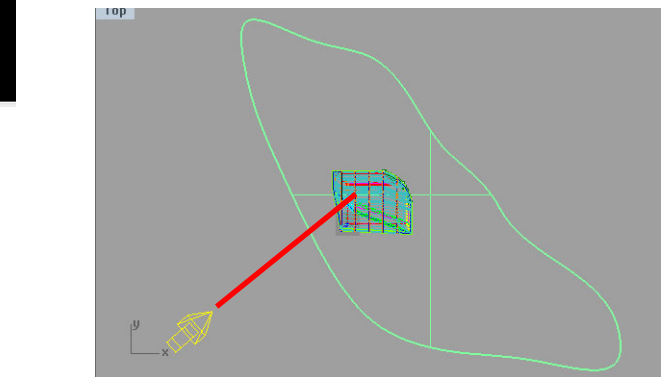
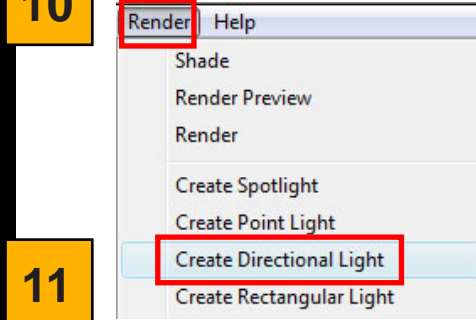
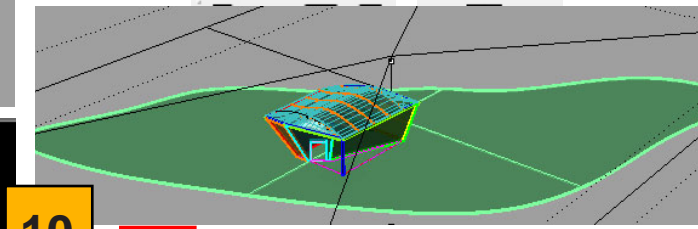
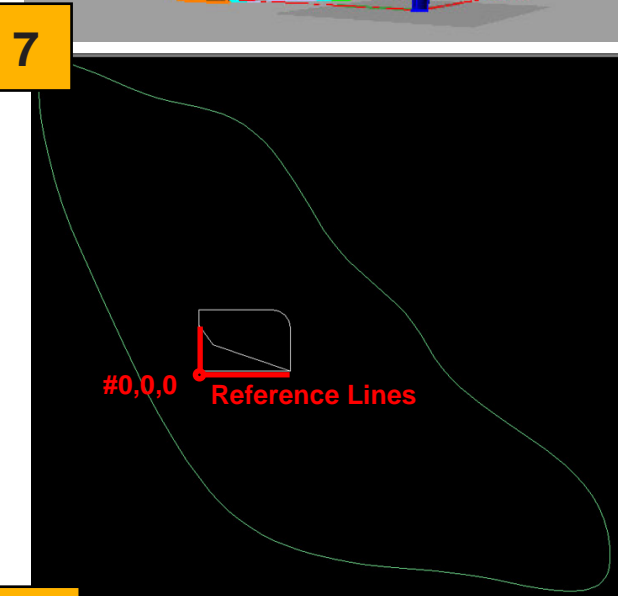
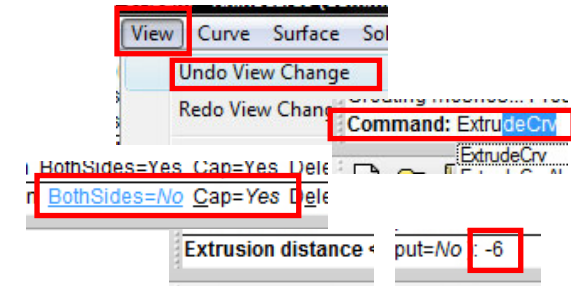
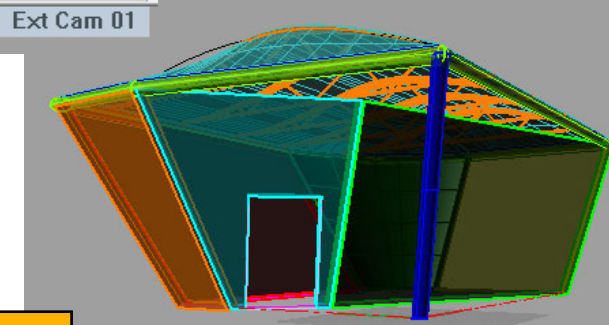

7

10

11

8

9

12

### Class SEVEN: Presentation

Viewport Shading \_ Cameras \_ Site Extrude \_ Directional Light (Sunlight) \_ Photoshop - canvas, guides, scale, text

**STEP THIRTEEN:** from the main menu click on the blue shaded sphere to render Ext Cam 01 \_ from the render window click on file / save \_ save in a Class-07 / images folder as class-07.jpg

**STEP FOURTEEN:** open Photoshop \_ ctrl+n \_ change the name to **Midterm Presentation** \_ set the width = **1280** pixels \_ set the height = **1024** pixels \_ set the background contents to **Transparent**

**STEP FIFTEEN:** in Photoshop open your class-02 site analysis assignment \_ **ctrl + a** (select all) \_ **ctrl + c** (copy) \_ **ctrl + tab** (tab over to midterm) \_ **ctrl + v** (paste) \_ **ctrl + t** (scale) \_ hold down the shift key while scaling to constrain proportions

**STEP SIXTEEN:** in the layers window double click on the layer name \_ re name the layer to **Site Diagram** \_ repeat step fifteen and sixteen for all of your class assignments (**tip:** when scaling click on the lock from the main options bar)

**STEP SEVENTEEN:** main menu \_ file / save as \_ save the file in your class-07 images folder as **Midterm Presentation.psd**

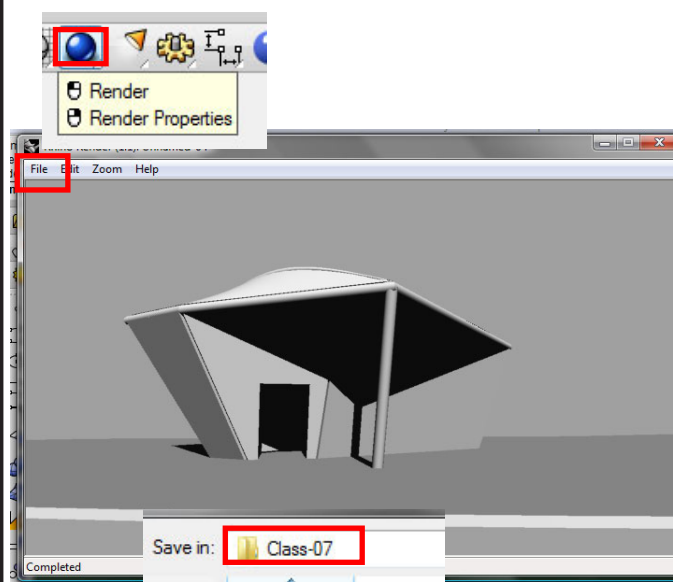

13

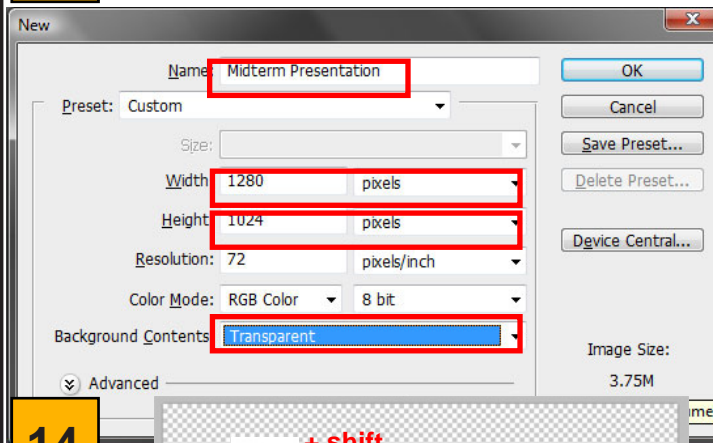

14

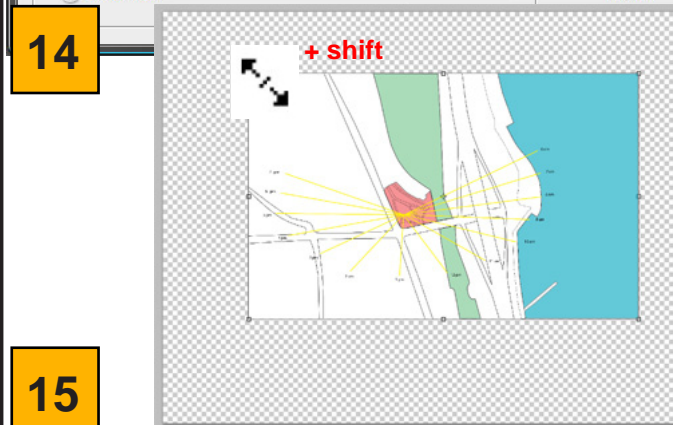

15

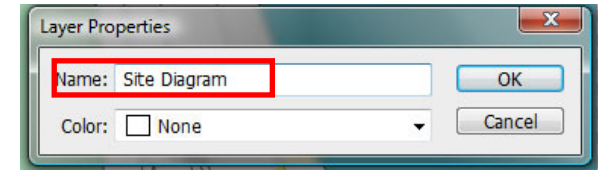
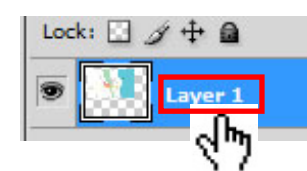

16

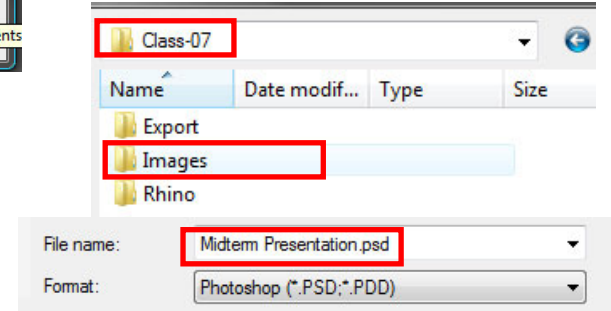
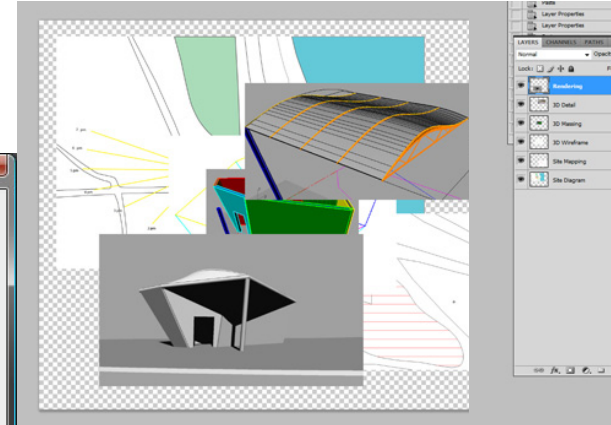
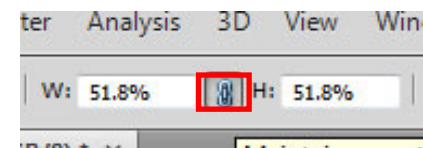

17

### Class SEVEN: Presentation

Viewport Shading \_ Cameras \_ Site Extrude \_ Directional Light  
(Sunlight) \_ Photoshop - canvas, guides, scale, text

**STEP EIGHTEEN:** in Photoshop **ctrl + r** will show and hide rulers \_ using the zoom tool in Photoshop \_ zoom into the upper left of the canvas place your cursor in the horizontal ruler \_ drag out a horizontal ruler to 5 pixels place your cursor in the vertical ruler \_ drag a vertical guide to 5 pixels

**NINETEEN:** repeat step nineteen for the other three corners \_ drag out a vertical line to 700 px \_ drag out a second to 710 px \_ place the site diagram in the upper left \_ **ctrl + t** \_ scale it to the 700 px vertical guide

**STEP TWENTY:** place the site diagram in the upper right \_ **ctrl + t** \_ scale it to the 710 px vertical guide

**STEP TWENTY ONE:** place a horizontal guide at 450 px \_ place another at 600 px \_ scale the 3D wireframe image to fit the height between 450 & 600 px

**STEP TWENTY TWO:** scale the 3D massing and 3D detail images to fit height between 450 & 600px \_ arrange as shown in image 22

**STEP TWENTY THREE:** place a horizontal guide at 620 px \_ align the ghosted perspective image as shown in image 23

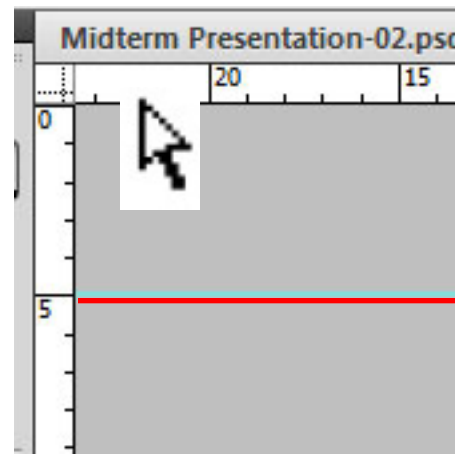

18

21

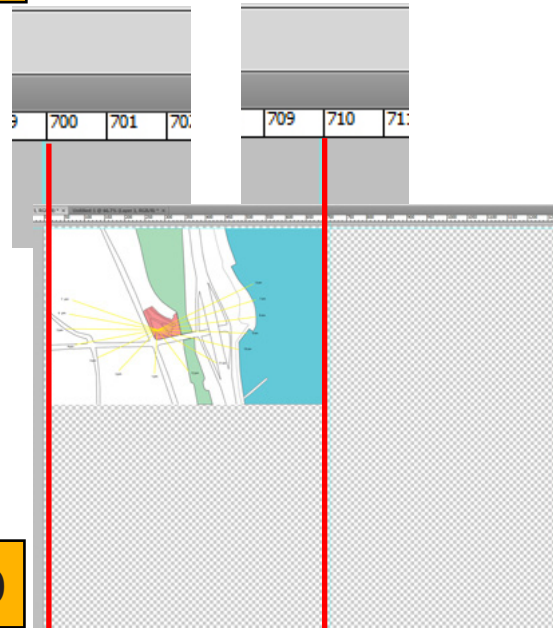
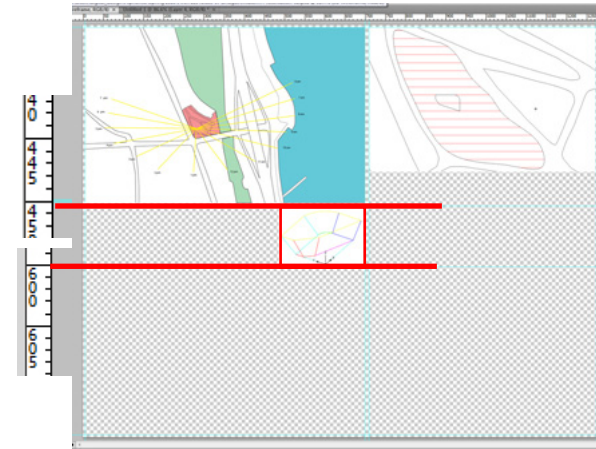

19

22

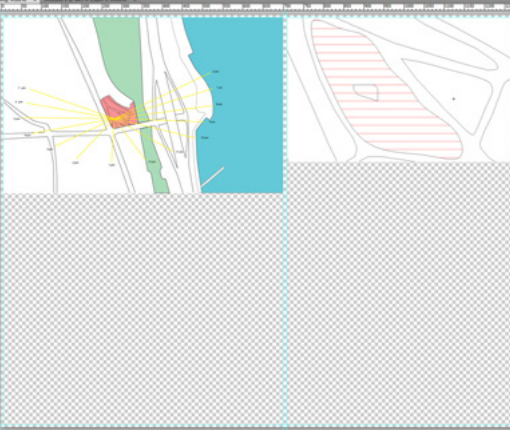
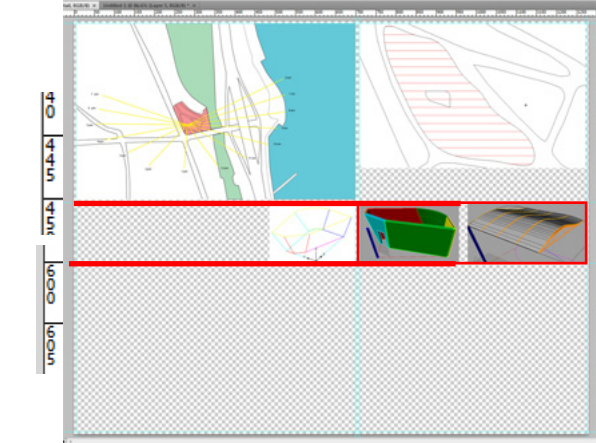

20

23

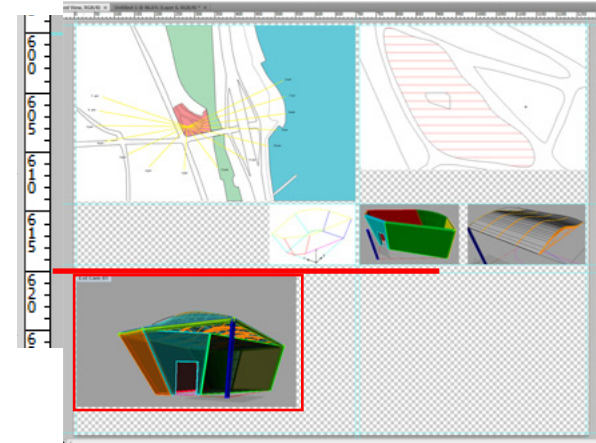

Arch 125  
Class-07 Spring 2010

**Class SEVEN: Presentation**

Viewport Shading \_ Cameras \_ Site Extrude \_ Directional Light (Sunlight) \_ Photoshop - canvas, guides, scale, text

**STEP TWENTY FOUR:** place the rendering in the lower right hand corner

**STEP TWENTY FIVE:** from the tools panel click on the **Text** tool \_ click in the blank area above the 3D massing and detail images \_ type in all caps PAVILION ON THE MARINA \_ in the character panel (upper right) \_ change the font to **Arial** \_ change the font height = **30 pt**

**STEP TWENTY SIX:** to edit the text double click on the T from the **Layers** window \_ highlight the entire line of text \_ change the tracking = **200** (spacing between letters)

**STEP TWENTY SEVEN:** using the **Text** tool \_ click under the Site Analysis image \_ Type Design Description \_ set the font height = **18 pt** \_ set the tracking = **200** \_ press enter \_ type My design concept for this pavilion was based on... \_ set the font height = **14 pt** \_ set the tracking = **0**

**STEP TWENTY EIGHT:** using the **Text** tool \_ add titles to all of the images \_ set the font height = **14 pt** \_ set the tracking = **0** \_ **Ctrl + J** (shortcut for copy layer)

**STEP TWENTY NINE:** using the **Text** tool in the lower left \_ add your name \_ Arch 125 \_ instructors name \_ midterm \_ **Ctrl + H** (to hide the guides) \_ **Ctrl + S** (save) \_ Save as a jpeg with a quality of 12

**Assignment 07:**

See Midterm Assignment

24

25

26

27

28

29

30

31

32

33